

# Vertical Toilet lift

## INSTALLATION MANUAL

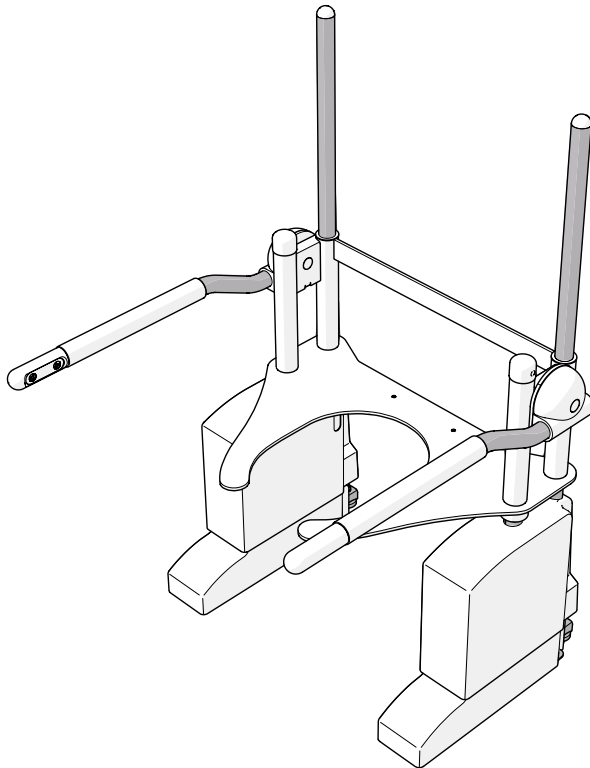

## ABOUT THIS MANUAL

---

This manual contains instructions and safety information for installation and maintenance of the Aerolet® vertical toilet lift.

### Language

The original manual is written in UK English. All other language versions are translations of the original manual.



### Intended readers

This manual is intended for:

- The technician that installs or performs maintenance on the machine

### Symbols used

This manual contains safety instructions that may result in injury when ignored. Each safety warning is indicated with a signal word. The signal word corresponds with the level of risk of the described hazardous situation:

Safety symbol	Level of risk	Result if not avoided
 <b>WARNING</b>	Medium	Could result in death or serious injury.
 <b>CAUTION</b>	Low	Could result in moderate or minor injury or damage to the machine.

Safety warnings given at the start of a section apply to the entire section.

### Other symbols used

This manual contains symbols that indicate useful information that complements the instructional text and illustrations.

Symbol	Meaning
 <b>NOTICE</b>	Messages that are not hazard-related are indicated with the signal word NOTICE. These messages do not have a safety alert symbol.

# TABLE OF CONTENTS

---

<b>1. Product</b>	<b>4</b>
1.1. Intended use	4
1.2. Reasonably foreseeable unintended use	4
1.3. General specifications	4
<b>2. Description</b>	<b>6</b>
2.1. Main parts	6
2.2. Controls	7
<b>3. Safety</b>	<b>10</b>
3.1. Personal protective equipment	10
3.2. Safety features	10
3.3. Safety symbols and labels on the product	10
3.4. Safety warnings and regulations	10
<b>4. Transport and storage</b>	<b>12</b>
<b>5. Installation</b>	<b>12</b>
5.1. Remove packaging	12
5.2. Contents of the package	12
5.3. Requirements for the location of installation	14
5.4. Preparation	15
5.5. Mounting	17
5.6. Add-ons	31
5.7. Adjusting	31
<b>6. Use</b>	<b>32</b>
6.1. Resetting	32
<b>7. Troubleshooting</b>	<b>32</b>
<b>8. Maintenance</b>	<b>33</b>
8.1. Repair	33
<b>9. Decommissioning</b>	<b>33</b>
<b>10. Warranty</b>	<b>34</b>
<b>11. Disposal</b>	<b>34</b>
<b>Attachments</b>	<b>35</b>

# 1. PRODUCT

---

## 1.1. Intended use

The essential performance of the toilet lift is to:

- Assist individuals with reduced mobility in using the toilet. The device helps to lower and lift the user on the toilet.
- Assist caregivers who help individuals with reduced mobility to make use of the toilet.

The essential performance of the toilet lift must be what it is intended to be and what the end user can expect. If the intended purpose of the essential performance is lost or deteriorates, the product is no longer suitable for the user.

## 1.2. Reasonably foreseeable unintended use

The following is considered foreseeable misuse:

- Use of the machine that deviates from the intended use as described in the previous section.
- Failure to comply with the instructions in this manual.
- Failure to eliminate faults, malfunctions or defects of the machine that impose safety risks.
- Failure to carry out the inspections and maintenance operations as described in this manual.
- Unauthorised removal or modification of parts or safety components of the machine.
- Use of spare parts or accessories that have not been approved by the manufacturer.

## 1.3. General specifications

The most important specifications can be found on the type plate. The type plate can be found on the right hand side, at the back of the toilet frame.

---

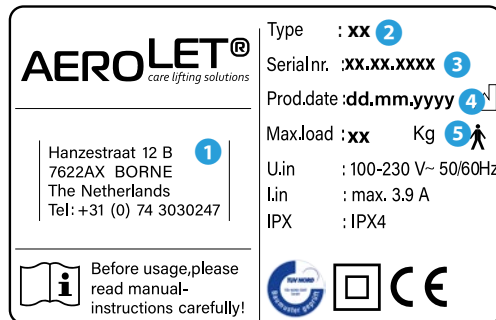

*Example of a type plate*

---

- |                                |                        |
|--------------------------------|------------------------|
| 1 Contact details manufacturer | 4 Production date      |
| 2 Type code                    | 5 Maximum nominal load |
| 3 Serial number                |                        |

The table below is a full overview of all the technical specifications:

<b>Specification</b>	<b>Value</b>
Name of the machine	Aerolet® vertical toilet lift
Length, width and height	61-69 x 73 x 112 cm
Weight	30 kg
Voltage	100-230 V
Frequency	50/60 Hz
Capacity	Max. 3.9 A
Working speed	55 mm/sec
Sound level	3.5 dB
Operating and storage temperature	5 – 40 °C
Operating and storage humidity	20 - 60%
Operation altitude	Max. 2000 m
Warranty	2 years

## 2. DESCRIPTION

---

### 2.1. Main parts

This is an overview of the main parts of the Aerolet® vertical toilet lift:

---

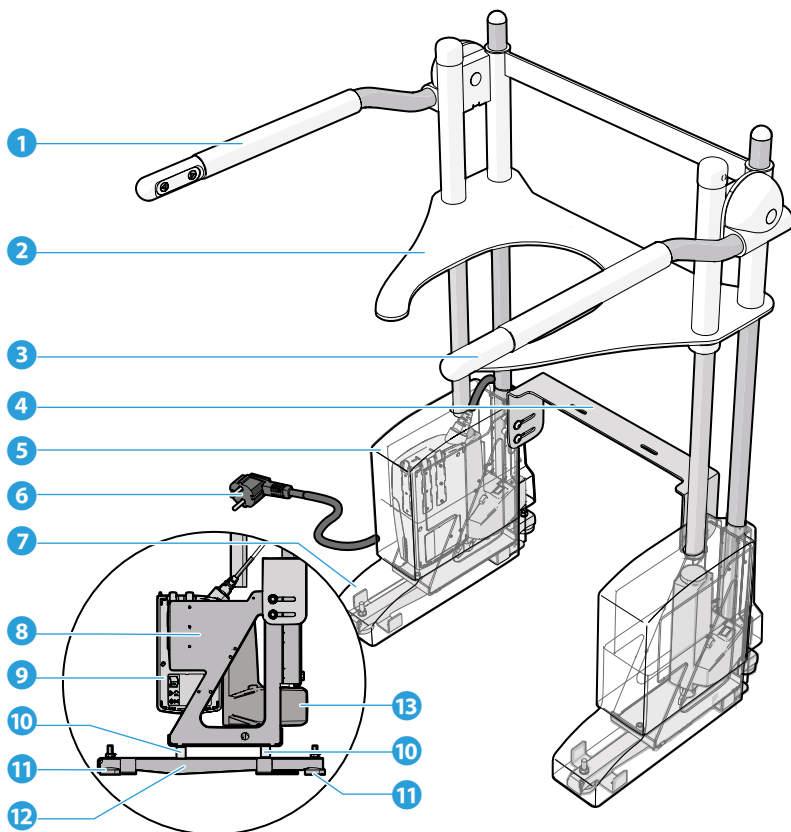

- 1 Right arm support
- 2 Toilet seat
- 3 Left arm support
- 4 Connecting bracket
- 5 Top cover
- 6 Power plug
- 7 Foot cover

- 8 Drive unit
- 9 Control box
- 10 Height adapter
- 11 Levelling feet
- 12 Floor frame
- 13 Actuator

The following add-ons are available:

#### **Battery back-up**

- The toilet lift can be equipped with a battery backup. This battery backup ensures that the lift can operate in the event of a power failure.

#### **Bidet system**

- If the type code (see type plate) is VE-BI-ST, VE-BI-SM or VE-BI-BA, the toilet lift can be equipped with a surface-mounted bidet system. The bidet-system can be bought and installed by an external company.

### **2.2. Controls**

---

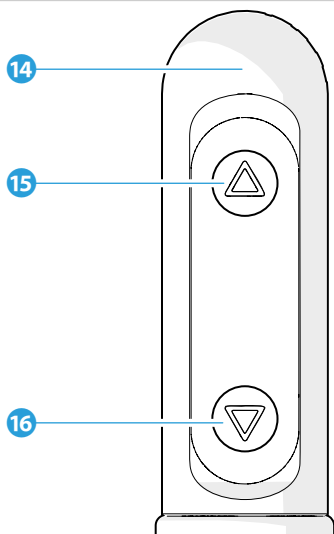

- 
- 14 Arm support control
  - 15 Arm support up-button

- 16 Arm support down-button

The following control add-ons are available:

**Easy-to-use button**

- The regular armrest control buttons can be replaced for push buttons at the front of the armrests. This is useful for users with reduced muscle strength or hand function.

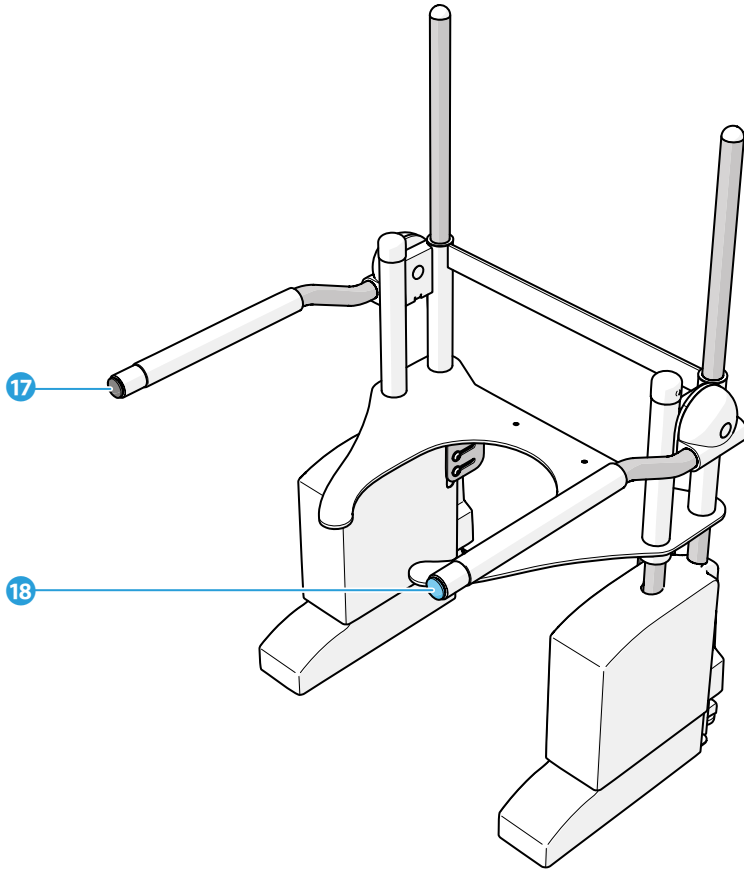

17 Easy-to-use down-button

18 Easy-to-use up-button

### Hand remote control

- Aside from the regular armrest control buttons, a hand remote can be installed. This is useful for caregivers to operate the toilet lift.

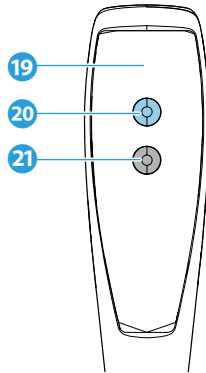

- 19 Hand remote
- 20 Hand remote up-button

- 21 Hand remote down-button

### Foot control

- Aside from the regular armrest control buttons, a foot control can be installed. This is useful for users with reduced hand and/or finger mobility.

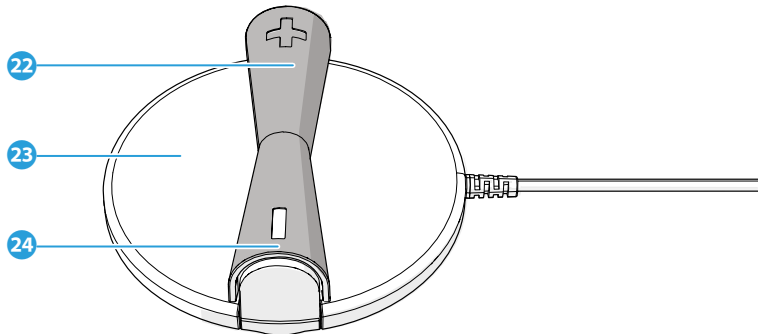

- 22 Foot control up-button
- 23 Foot control

- 24 Foot control down-button

## 3. SAFETY

---

### 3.1. Personal protective equipment

During installation and maintenance, it is recommended to wear rubber gloves to protect against harmful bacteria and chemicals.

### 3.2. Safety features

To minimize the risk of a fire hazard or electric shock, the device is equipped with short-circuit protection, thermal protection, hot-plug protection and overload protection.

To protect the device against water damage, and to protect the user from electric shock, the device is equipped with a plastic seating cover and foot cover.

To warn the user when there is an electronics error or if the battery back-up (add on) is empty, the device makes a constant beep sound.

### 3.3. Safety symbols and labels on the product

This is an overview and explanation of all inflicted safety symbols and labels on the product.

---



Warning: Fully lower the toilet lift after use.

---



Warning: Risk of entrapment

---



Maximum weight indication of 150 kg / 330 lbs.

---



Maximum weight indication of 250 kg / 550 lbs.

---

### 3.4. Safety warnings and regulations

#### 3.4.1. General safety warnings

##### **⚠ WARNING**

- Risk of serious injury. Ensure you have fully read and understood the instructions in this document before you install or use the product. Keep the packaging and this document for future reference.
- Risk of serious injury. Always use the product as described in this document.
- Risk of serious injury. Never use the product if a part is damaged or defective. Replace a damaged or defective product or part immediately. Always check the product for damage before use.

##### **⚠ CAUTION**

- Risk of product damage. High temperatures can cause overheating. Never operate the lift in temperatures above 40 degrees Celsius.
- Risk of product damage. Excessive humidity can cause electrical issues and product malfunction. Never operate the lift when humidity exceeds 60%.
- Risk of product damage. Always use the specified power supply. Ensure you use the correct power specifications.

### 3.4.2. Safety warnings for transport

#### **⚠ WARNING**

- Risk of product damage. Never drop or handle the lift roughly during transport. Handle with care.

### 3.4.3. Safety warnings for installation

- Improper installation hazard. Risk of serious injury and product malfunction. Always install the device by trained and authorized personnel. Follow the installation instructions carefully.
- Electrical hazard. Risk of fire or serious injury. Risk of short-circuiting or unstable product due to improper installation. Follow all local electrical safety codes when installing the lift. Adhere to safety regulations.
- Improper hardware hazard. Risk of product malfunction and serious injury. Use only the mounting hardware mentioned in this manual.
- Product instability hazard. Risk of serious injury due to a loose toilet bowl. A loose toilet bowl can result in an unstable toilet lift. Always anchor the toilet bowl solidly to the floor or wall. Always ensure the lift is installed on a stable and level surface. Verify the surface before installation.
- Product instability hazard. Risk of serious injury due to a loose or cracked toilet seat. Ensure the seat is securely fixed. Only use the recommended toilet seat with the correct fixing materials.

#### **⚠ CAUTION**

- Risk of product malfunction. High altitudes can affect the lift's performance and safety. Never install the device above an altitude of 3000 meters.
- Risk of product malfunction. Testing ensures the lift is functioning correctly and safely. Always perform a lift operation test after installation.

### 3.4.4. Safety warnings for maintenance

#### **⚠ WARNING**

- Risk of electrical shock. Disconnect the power supply before performing any maintenance. Always unplug the device first.
- Improper maintenance hazard. Risk of serious injury and product malfunction. Always repair the device by trained and authorized personnel. If the toilet lift is not repaired by an authorised body, there is a risk of malfunction and the warranty may be withdrawn.

## 4. TRANSPORT AND STORAGE

---

### **⚠ CAUTION**

Risk of product damage. Never drop or handle the lift roughly during transport. Handle with care.

---

The toilet lift is delivered by Aerolet on a pallet in a protected package which weighs 30 kg. It is recommended to:

- Transport the toilet lift in an upright position
- Transport in the provided packaging box to protect the product from dust and debris.

## 5. INSTALLATION

---

### **⚠ WARNING**

Improper installation hazard. Risk of serious injury and product malfunction. Always install the device by trained and authorized personnel. Follow the installation instructions carefully.

---

### **5.1. Remove packaging**

To remove the packaging material from the toilet lift, gently cut along the taped seams with a utility knife, taking care not to press too hard to avoid scratching the surface. Slowly peel away any protective plastic foil or foam cushioning.

### **5.2. Contents of the package**

Check if all parts are present and undamaged. In case of missing or damaged parts, please contact your supplier.

1. Vertical toilet lift
2. Height adapter bushes, (if applicable)
3. Mounting set 1, 2, 3, or 4
4. Wrench size 13
5. Installation checklist

Depending on the type of toilet bowl, one of the following mounting sets is supplied:

## Mounting set 1 – Suitable for conventional toilet bowl

---

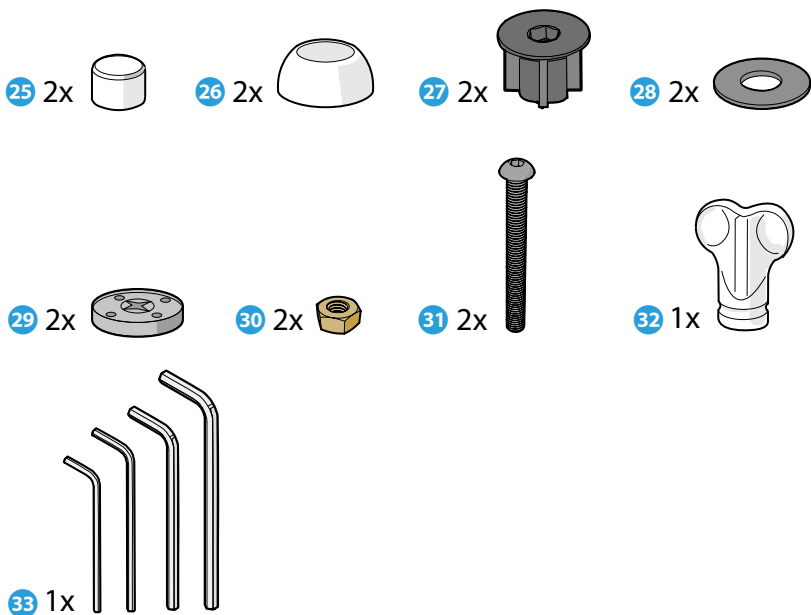

- 25 Bolt cover cap
- 26 Bottom cover cap
- 27 Centering bush
- 28 Rubber ring
- 29 Lock washer
- 30 M6 nut
- 31 M6 80 mm bolt
- 32 Mounting key
- 33 Allen wrench set

## Mounting set 2 – Suitable for Geberit Mera toilet bowl

---

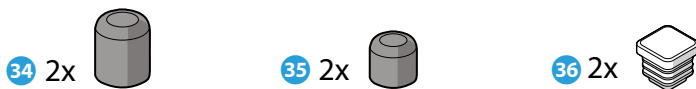

- 34 Large round end cap
- 35 Small round end cap
- 36 Toilet lid sealing cap

### Mounting set 3 – Suitable for Closomat Palma toilet bowl

---

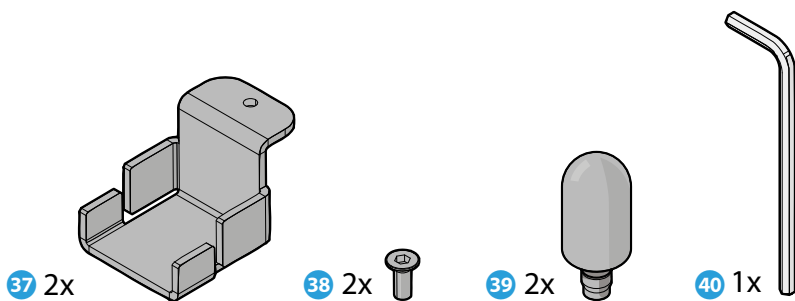

- 37 Anchor plate
- 38 Anchor plate bolt

- 39 Seat lugs
- 40 Allen wrench

### Mounting set 4 – Suitable for JHC/Washair toilet bowl

---

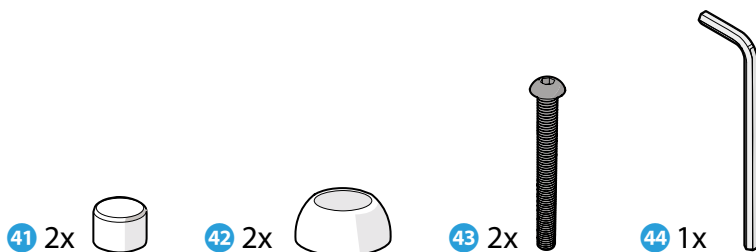

- 41 Bolt cover cap
- 42 Bottom cover cap

- 43 M6 60 mm bolt
- 44 Allen wrench

### 5.3. Requirements for the location of installation

#### **CAUTION**

Risk of product malfunction. High altitudes can affect the lift's performance and safety. Never install the device above an altitude of 3000 meters.

The location of installation has the following requirements:

- One 230V Power outlet within 2 meters of the toilet bowl. If the power outlet is not within range, use an extension cord.
- A toilet bowl, securely connected to the floor or wall and level with the floor.
- Additional power outlet and water point within 2 meters in case of the bidet system add-on.

## 5.4. Preparation

### 5.4.1. Preparation of the installation site

Check if the location of installation has a 230 V Power outlet within 2 meters of the toilet bowl. If not, plug in an extension cord.

Check that the installation site has the following minimum dimensions for placement of the toilet lift:

Measurement	Measurement requirement
Distance A	Min. 105 mm
Distance B	Min. 50 mm
Distance C	Min. 100 mm

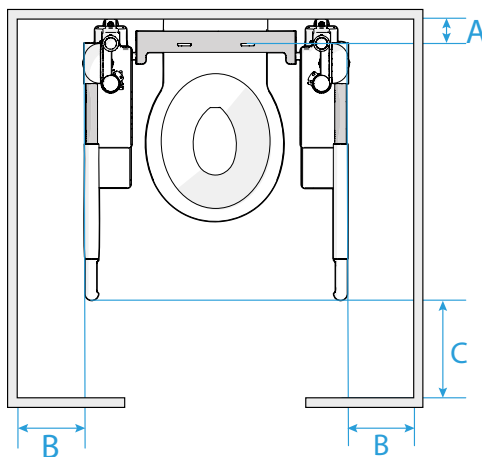

### 5.4.2. Preparation of toilet bowl

Remove the toilet seat from the toilet bowl. Consult the manual of your specific toilet.

### 5.4.3. Preparation of toilet lift

Measure the height of the toilet bowl. Is the height more than 400 mm, install a toilet raising set.

#### Install toilet raising set

**NOTICE**



Scan the QR code to access all Aerolet's installation videos online.

1. Carefully tilt the toilet lift back and ensure that the floor frames **12** are clear of the ground. Use a pair of support objects, such as wooden blocks, to support the toilet lift.
  2. Open the velcro connection on the left and right foot covers **7** and push the foot covers slightly upwards.
  3. Remove the floor frame bolts and the floor frame **12**.
- 

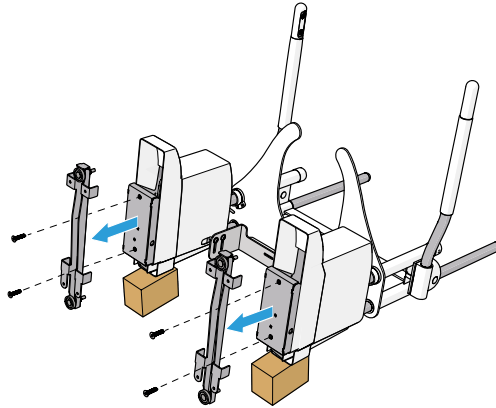

4. Attach the height adapter bushings to the floor frame **12** with bolts as depicted in the image.
- 

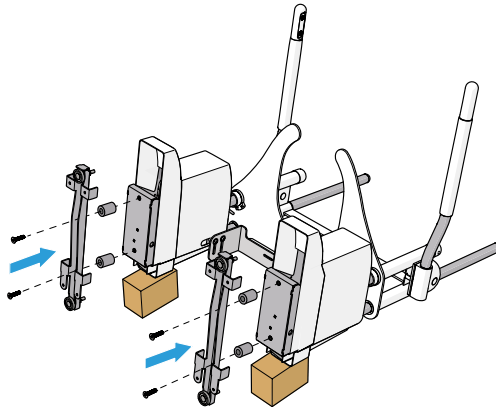

5. Slide foot cover **7** back over floor frame **12** and press the velcro connections closed.
6. Carefully set the toilet lift upright and continue with the installation procedure.

## 5.5. Mounting

### **WARNING**

Product instability hazard. Risk of serious injury due to a loose toilet bowl. A loose toilet bowl can result in an unstable toilet lift. Always anchor the toilet bowl solidly to the floor or wall. Always ensure the lift is installed on a stable and level surface. Verify the surface before installation.

### 5.5.1. Mounting toilet lift on a conventional toilet bowl

#### **NOTICE**



Scan the QR code to access all Aerolet's installation videos online.

1. Push the foot covers **7** slightly upwards.

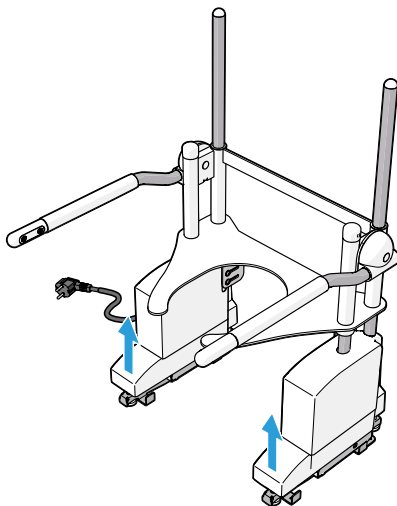

2. Connect the power plug **6** to a power outlet.
  3. Raise the toilet lift approximately 10 cm by pushing the arm support up-button **15**.
- 

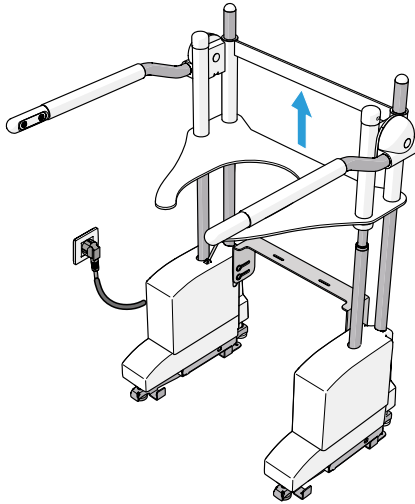

4. Press two centering bushes **27** into the toilet bowl fixing holes. Cut the centering bushes to size if necessary.
- 

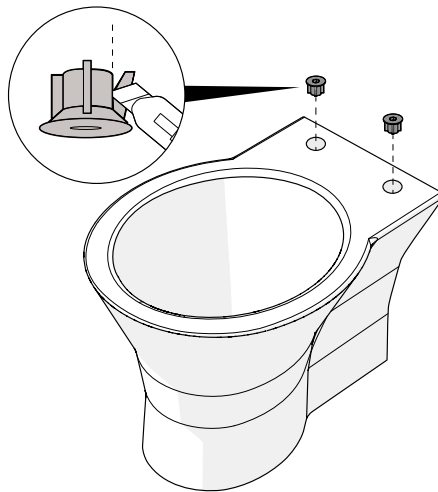

5. Lift the toilet lift by the arm supports. Slide the toilet lift over the toilet bowl and align the slotted holes in the connecting bracket **4** with the centering bushes.
6. Adjust the levelling feet **11** until the toilet lift is level with the toilet.

7. Adjust the depth of the lift by aligning the front of the toilet lift with the front of the toilet bowl and tighten the connecting bracket bolts.
- 

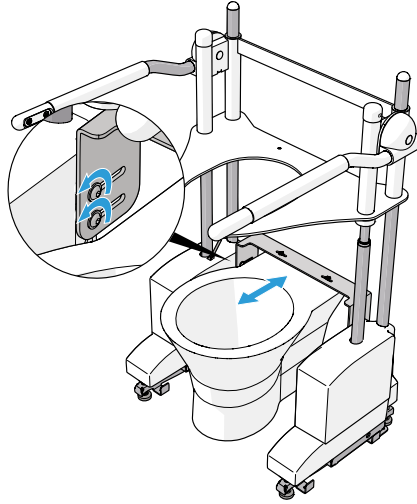

8. Place the rubber rings 28 between the connecting bracket and the toilet bowl.  
9. Push two M6 80mm bolts 31 with bottom cover caps 26 through the connecting bracket, rubber dampers and centering bushes.  
10. Place lock washers 29 on the underside of the toilet bowl and fasten the M6 80mm bolts to the connecting bracket with an M6 nut 30.  
11. Cover the M6 80mm bolt with a bolt cover cap 25.
- 

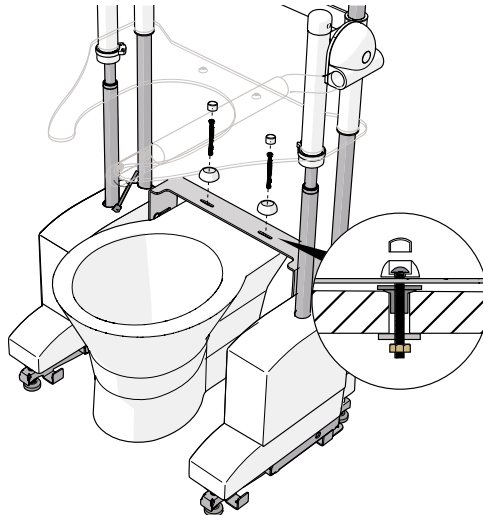

12. Lower the foot covers and fasten the velcro connections.

### 5.5.2. Mounting toilet lift on a Geberit Mera

---



**NOTICE**

Scan the QR code to access all Aerolet's installation videos online.

---

1. Remove the toilet seat and lid from the Geberit Mera. Refer to the Geberit Mera instruction manual for detailed instructions.
  2. Push toilet lid sealing caps **36**, small round end caps **35** and large round end caps **34** in the holes left by the toilet lid as indicated in the illustration.
- 

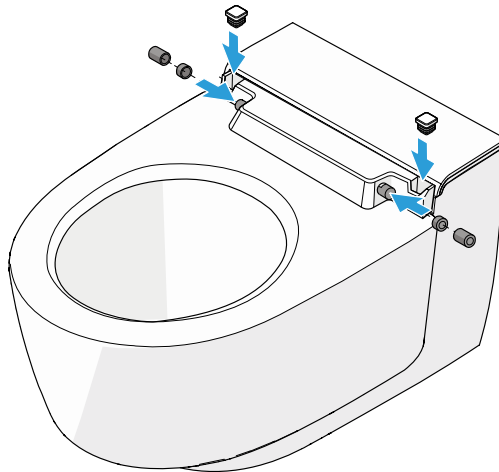

3. Unscrew the plastic set screws on the connecting bracket 4.

---

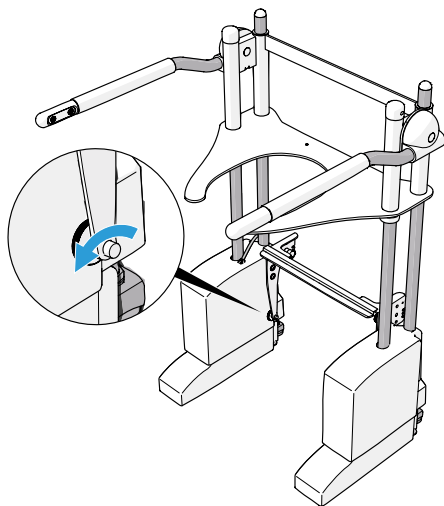

4. Push the foot covers 7 slightly upwards.

---

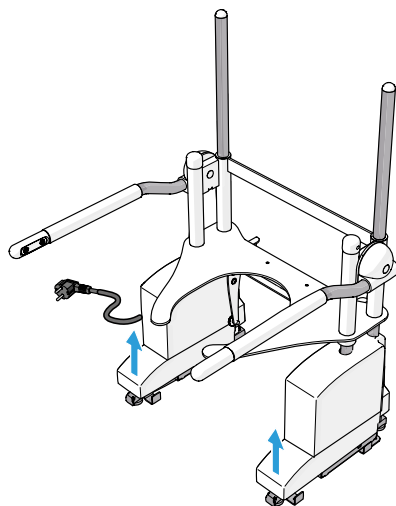

5. Connect the power plug **6** to a power outlet.
  6. Raise the toilet lift approximately 10 cm by pushing the arm support up-button **15**.
- 

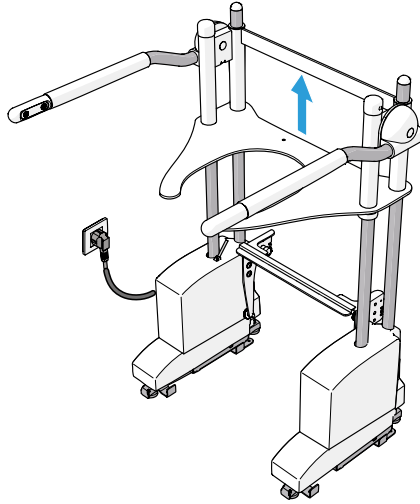

7. Lift the toilet lift by the arm supports **1** **5**. Place the toilet lift over the Geberit Mera and slide through until the cams of the connecting bracket fall behind the toilet bowl.
- 

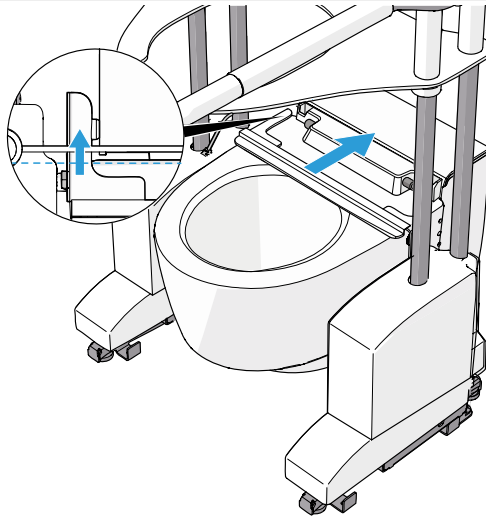

8. Adjust the levelling feet **11** until the toilet lift is level with the toilet.
9. Tighten the plastic set screws against the toilet bowl on either side.

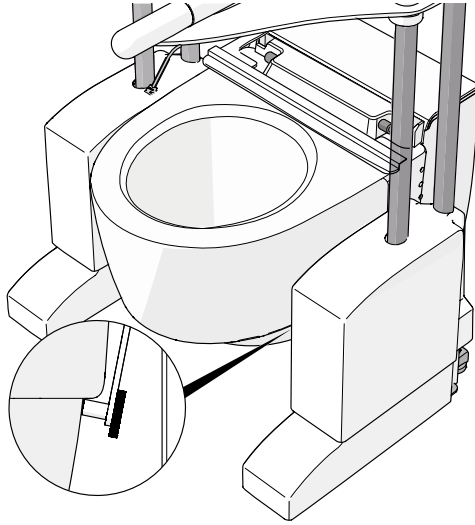

10. Lower the foot covers and fasten the velcro connections.
11. If desired, place the toilet seat back on the toilet lift.

### 5.5.3. Mounting toilet lift on a Closomat Palma

**NOTICE**



Scan the QR code to access all Aerolet's installation videos online.

1. Remove the toilet seat and lid from the Closomat Palma. Refer to the Closomat Palma instruction manual for detailed instructions.
2. Remove the top cover from the Closomat Palma. Refer to the Closomat Palma instruction manual for detailed instructions.

3. Place the seat lugs **39** on the holes left by the toilet seat.

---

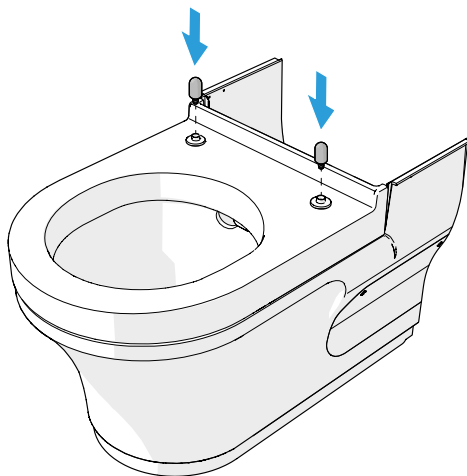

4. Hook the anchor plates **37** behind the toilet bowl.

---

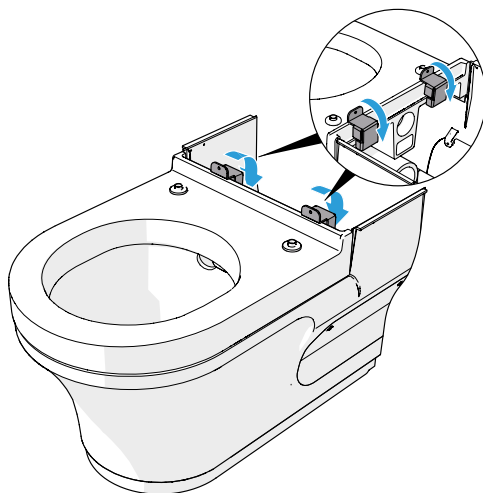

5. Push the foot covers **7** slightly upwards.
- 

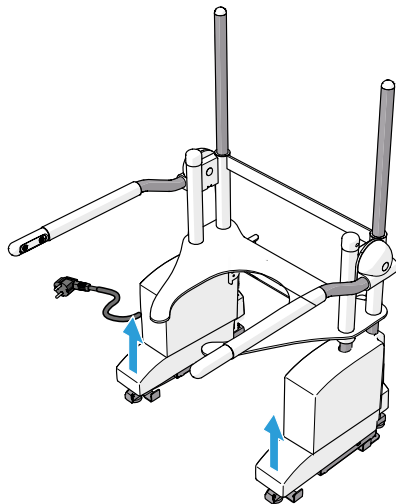

6. Connect the power plug **6** to a power outlet.  
7. Raise the toilet lift approximately 10 cm by pushing the arm support up-button **15**.
- 

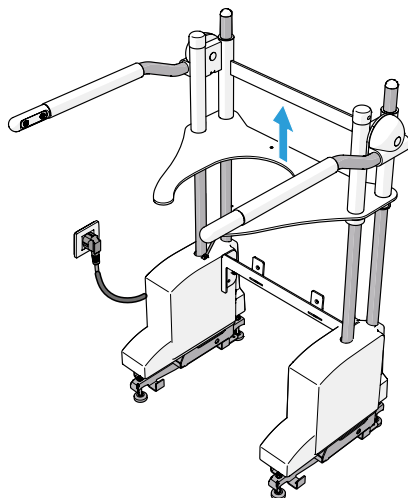

8. Lift the toilet lift by the arm supports 1 3. Slide the toilet lift over the toilet bowl and align the holes of the connecting bracket 4 with the holes on the anchor plates.
  9. Adjust the levelling feet 11 until the toilet lift is level with the toilet.
  10. Attach the anchor plates onto the connecting bracket with the anchor plate bolts 3B.
- 

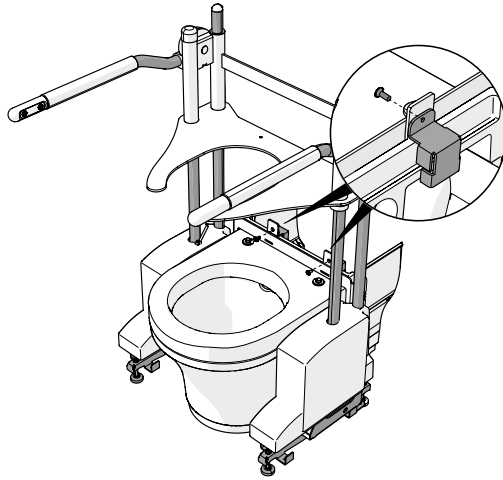

11. Re-install the top cover. Refer to the Closomat Palma instruction manual for detailed instructions.
  12. Lower the foot covers and fasten the velcro connections.
- 

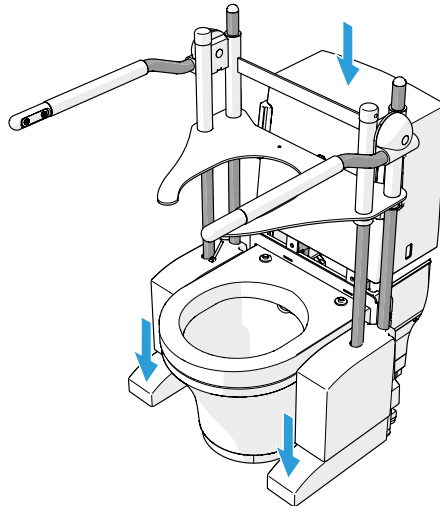

#### 5.5.4. Mounting toilet lift on a JHC/Washair

---

**NOTICE**



Scan the QR code to access all Aerolet's installation videos online.

---

Avoid activation of the bidet function. Never use the remote control while installing the toilet lift.

---

1. Remove the toilet seat and lid from the JHC or Washair toilet. Refer to the JHC or Washair instruction manual for detailed instructions.
  2. Remove the toilet seat axes from the toilet bowl with pliers.
- 

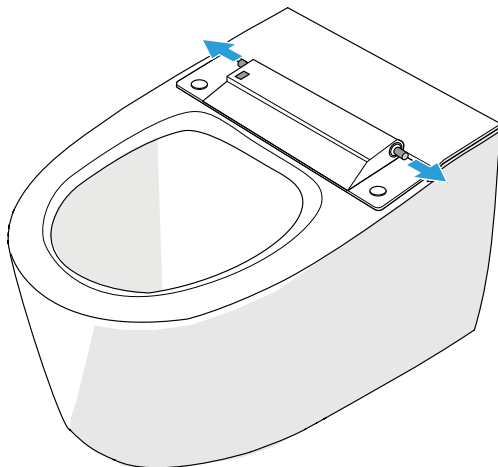

3. Remove the cover caps located on top of the toilet and push the cover caps in the holes left by the toilet seat axes.
- 

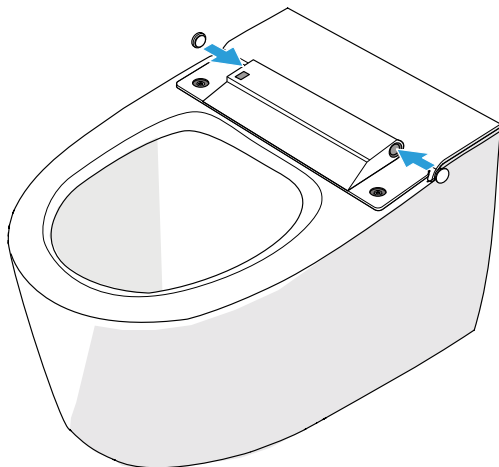

4. Remove the bidet fastening screws.
- 

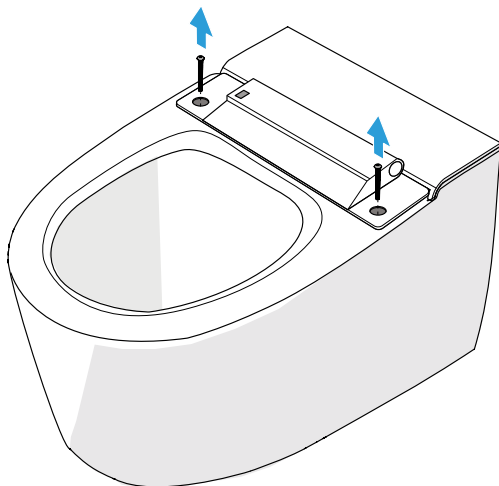

5. Push the foot covers 7 slightly upwards.

---

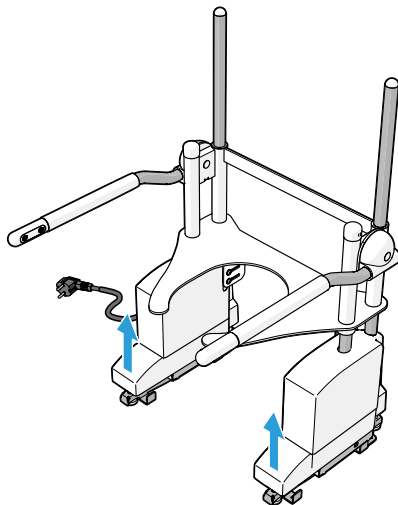

6. Connect the power plug 6 to a power outlet.

7. Raise the toilet lift approximately 10 cm by pushing the arm support up-button 15.

---

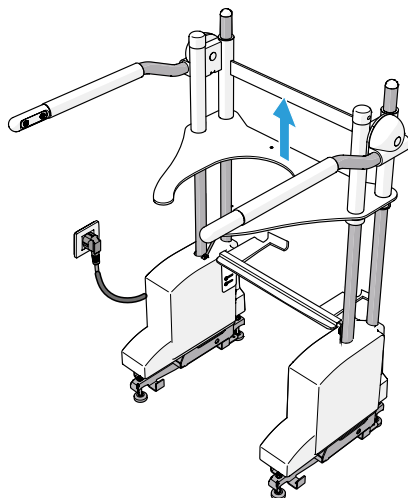

8. Lift the toilet lift by the arm supports ① ③. Slide the toilet lift over the toilet bowl and align the holes of the connecting bracket ④ with the holes on the bidet.
  9. Adjust the levelling feet ⑪ until the toilet lift is level with the toilet.
  10. Screw the M6 60mm bolt ⑬ with the bottom cover cap ⑭ in the bidet holes.
  11. Push the bolt cover cap ⑮ in the bottom cover cap.
- 

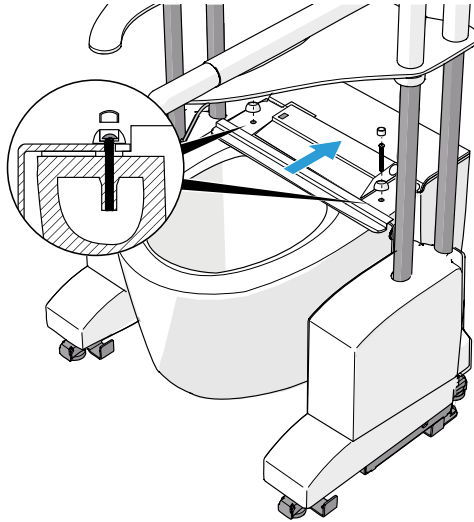

12. Lower the toilet lift to the lowest position by pushing the arm support down-button ⑯.
13. Check if the toilet seat rests on the toilet bowl.  
If necessary, turn the levelling feet to adjust the height.
14. Lower the foot covers and fasten the velcro connections.
15. If desired, place the toilet seat back on the toilet lift.

## 5.6. Add-ons

Add-ons such as the hand remote control and/or foot control will, in most cases, be delivered pre-installed on the toilet lift. If this is not the case, refer to the service manual for installation instructions on [www.aeroletnl.com](http://www.aeroletnl.com).

## 5.7. Adjusting

### 5.7.1. Arm support angle

The angle of the arm support controls can be adjusted.

1. Loosen the allen bolts at the bottom of the arm supports with an allen key.
- 

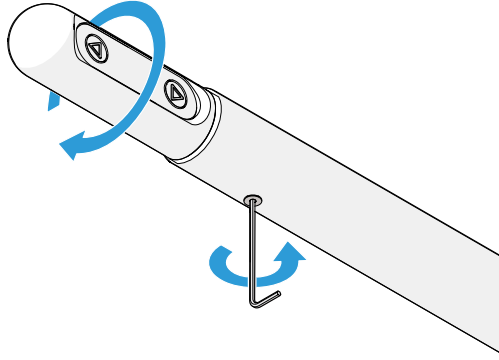

2. Rotate the arm support controls in the desired position.
3. Tighten the allen bolt.

## 6. USE

Risk of product malfunction. Never exceed the maximum weight capacity. Overloading can cause the lift to fail. Check the manufacturer's specifications.

### CAUTION

Risk of product damage. High temperatures can cause overheating. Never operate the lift in temperatures above 40 degrees Celsius.

Risk of product damage. Excessive humidity can cause electrical issues and product malfunction. Never operate the lift when humidity exceeds 60%.

### 6.1. Resetting

If the toilet lift makes a beep sound when one of the control buttons is pressed, reset the lift. Follow the following procedure to reset the toilet lift:

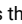
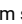
1. Press the arm support up-button  and down button  simultaneously and hold until the beep sound dies down.
2. Lower the toilet lift by pressing the arm support down-button. Bring the toilet lift at the lowest position.
3. Contact your dealer.

## 7. TROUBLESHOOTING

Problem	Possible cause	Solution
The toilet lift does not lift or lower.	The toilet lift is not connected to a power supply.	Connect the toilet lift to a power supply.
	Left, right control unit or both control units are defective.	Contact dealer.
	Arm support up-button and arm support down-button are pressed simultaneously.	Press arm support up-button or arm support down-button. Do not press simultaneously.
The toilet lift makes a beep sound when one of the control buttons is pressed.	The toilet lift has an electronics error.	Reset the toilet lift. See chapter 6.1..
The toilet lift makes a squeaking noise when the toilet lift is lifted or lowered.	The guide rods are greasy and/or dirty.	Clean and degrease the guide rods with a degreaser such as benzene.

## 8. MAINTENANCE

---

### 8.1. Repair

#### **⚠ WARNING**

Improper maintenance hazard. Risk of serious injury and product malfunction. Always repair the device by trained and authorized personnel. If the toilet lift is not repaired by an authorised body, there is a risk of malfunction and the warranty may be withdrawn.

#### **⚠ WARNING**

Risk of electrical shock. Disconnect the power supply before performing any maintenance. Always unplug the device first.

Improper maintenance hazard. Risk of serious injury and product malfunction. Always repair the device by trained and authorized personnel. If the toilet lift is not repaired by an authorised body, there is a risk of malfunction and the warranty may be withdrawn.

Repairs should be done by trained and authorized personnel. If repairs are done under warranty, send defective parts to Aerolet.

For repairs to the electronics, consult the electrical diagram in Attachment 2.

It is possible to order spare parts on request. Contact Aerolet for a parts list.

## 9. DECOMMISSIONING

---

In case of permanent or prolonged non-use, or for transport of the product, the following procedure should be followed to decommission the toilet lift.

1. Press the arm support up-button **15** to bring the toilet upwards.
2. Unscrew the carriage bolts from the connecting bracket **4**.

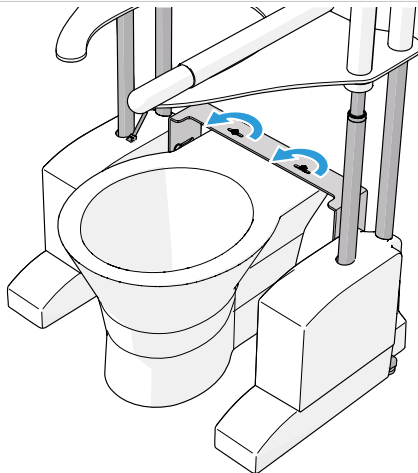

3. Disconnect the power plug **6** from the power outlet.
4. Lift the toilet lift by the arm supports **1** **3** and remove the toilet lift.

## 10. WARRANTY

---

Aerolet guarantees the Aerolet® vertical toilet lift against material and manufacturing defects for a period of two years from purchase by the end user. The warranty period starts either on the date of delivery, or on the installation date, when the installation has been carried out by Aerolet or by an authorised dealer. During this warranty period, Aerolet or an authorised dealer will, at its discretion, repair or replace any defective parts. Parts repaired under warranty should be returned to Aerolet.

The warranty on your Aerolet toilet lift does not apply to defects resulting from the following:

- Improper or inadequate maintenance by the user.
- Unauthorised adjustments and/or modifications or misuse.
- Use outside the environmental specifications for which the product is intended.

If the toilet lift is not opened by an authorised body, there is a risk of malfunction and the warranty may be withdrawn.

## 11. DISPOSAL

---



Separate and dispose the components of the machine into the applicable waste streams based on their materials, in accordance with local regulations.

---

## ATTACHMENTS

---

### Attachment 1. Declaration of conformity

Aerolet declares that the Aerolet® vertical toilet lift complies with the following directive: Medical Devices Regulation (EU) MDR 2017/745.

The product conforms to the following standards:

- EN 60601-1:2006
- EN 60601-1-2:2015
- EN-ISO 14971:2019+ A11:2021
- EN-ISO 13485:2016
- EN 1041:2008+A1:2013
- EN 6060-2
- NEN-EN 21856

### Attachment 2. Electrical diagram

---

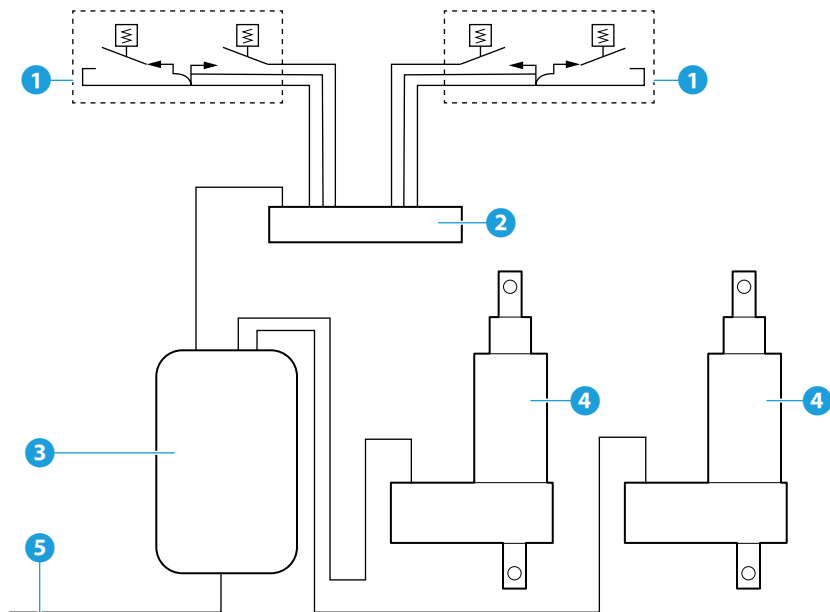

- ① Arm support control
- ② Splitterbox
- ③ Control box

- ④ Actuator
- ⑤ Power cord



**Aerolet**

Het Lentfert 38, 7547SR Enschede

[info@aerolet.nl](mailto:info@aerolet.nl)

[www.aerolet.nl](http://www.aerolet.nl) - [www.aeroletnl.com](http://www.aeroletnl.com)

Original user manual

v1.0 - 02/2025